

**GENERAL NOTES:**  
 The Contractor is aware on all details and ensure stability and strength of construction. The contractor to provide setting out and set drawings for approval prior to construction.  
 The contractor to check all dimensions on site and relate to these drawings. The contractor to report any discrepancies to design team prior to construction. All services to meet minimums, BS5303 & Environmental Health requirements and to Service Engineers.  
 All structure to Structural Engineer's details and shall comply with BS5951 requirements. All construction and materials to comply with the current Building and Fire Regulations.

Revision	Date	Description
A	April '16	Issued following LPA's pre-application input
B	June '16	Revised following tree survey.
C	June '16	Final presentation notes included.

previous studio footprint

1. Smaller footprint April 2016: revised following LPA pre-application feedback. Cross refer to tree & structural reports for approach to foundations.

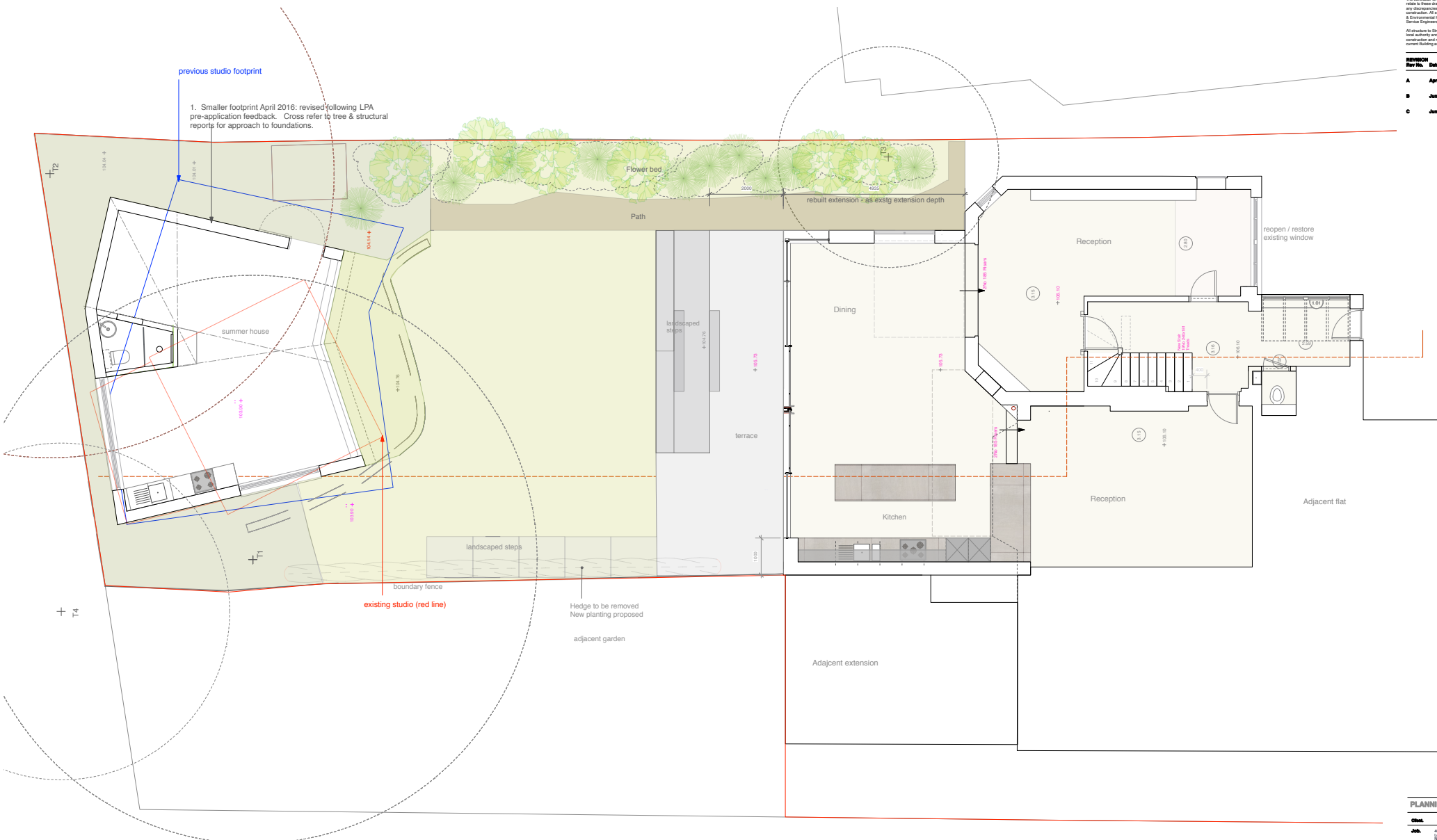

Proposed Ground Floor Plan 1:50



PLANNING	
<b>Client:</b>	M & M Sturt
<b>Job:</b>	43 B Holborn Avenue WC1N 3DA
<b>Title:</b>	Proposed Ground Floor Plan
<b>Date:</b>	Feb 2016
<b>Drawn by:</b>	WJ
<b>Checked by:</b>	AT
<b>Scale:</b>	1:50/51
<b>Drawing No.:</b>	1012-100
<b>Revision:</b>	C

**fabric space**  
 Studio 2/1, Canterbury Court,  
 1-3 Britton Road, London SE18 6DR  
 t: +44 (0) 7789 8888  
 e: info@fabric-space.com  
 www.fabric-space.com